

Swing-Arm® Clamps

for Series 806 Mil-Aero Connectors

870V004 Swing-Arm Saddle Clamp, Banding Adapter, Composite

Self-Locking



Adapter Code V

This accessory fits Glenair Series 806 Mil-Aero connectors

FIGURE 1

FINISH CODES NFS, BNS

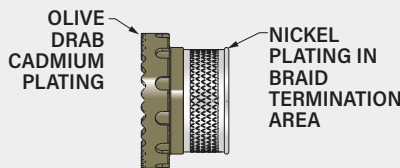
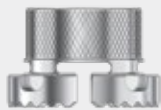

FIGURE 2

BANDING ADAPTER SLOTS CODE S



Route pigtail shield braids into optional "T" slots in banding adapter.

Shielded, self-locking, adjustable arms. 870V004 Swing-Arm saddle clamp fits Glenair Series 806 Mil-Aero connectors. Adjustable arms pivot to 0°, 45° or 90° positions. Banding adapter has optional "T" slots for pigtailed individual shields. Terminate shield braid to adapter with optional Band-Master ATS® pre-coiled banding strap. Full radius saddles with self-locking clinch nuts. Available in two clamp sizes: standard clamp fits most wire bundles, large clamp has increased clearance for oversize wire bundles. Coupling nut has anti-decoupling mechanism for audible detented coupling and prevents backoff under high vibration.

PART NUMBER

	870V004	M	22	A	S	K
Base P/N	870V004					
Banding Adapter Material/Finish	ME Alum/Electroless Nickel NF Alum/Olive Drab Cadmium NFS Alum/O.D. Cadmium, selective (fig. 1) MT Alum/Nickel-PTFE TZ Alum/Tin-Zinc BM Brass/Electroless Nickel BN Brass/Olive Drab Cadmium BNS Brass/O.D. Cadmium, selective (fig. 1) BMT Brass/Nickel-PTFE					
Shell Size	08 09 10 11 12 14 16 18 20 22 24					
Clamp Size	A Standard Clamp B Large Clamp					
Banding Adapter Slots	Omit if not required. See Figure 2. S "T" Slots in Banding Adapter for Shield Pigtails					
Band	Omit if not required. K Pre-Coiled Micro Band included With Clamp J Pre-Coiled Slim Micro Band included With Clamp					

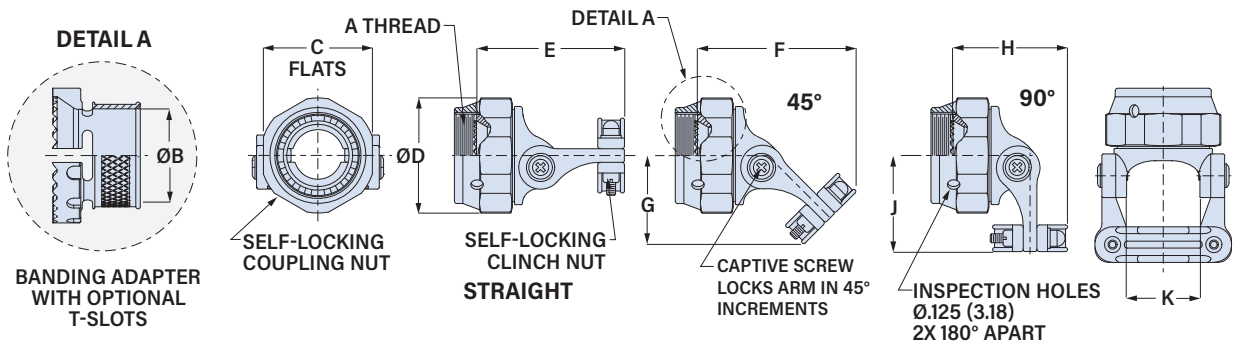

Shell Size	A Thread ISO Metric	øB Min in	mm	C Flats in	mm	D Max in	mm	E Max in	mm	F Max in	mm	G Max in	mm	H Max in	mm	J Max in	mm	K Ref. in	mm
08	M10 x 1.0-6H	.178	4.5	.750	19.1	.812	20.6	1.53	38.9	1.46	37.1	.79	20.1	1.01	25.7	.86	21.8	.393	10.0
09	M12 x 1.0-6H	.178	4.5	.750	19.1	.812	20.6	1.53	38.9	1.46	37.1	.79	20.1	1.01	25.7	.86	21.8	.393	10.0
10	M14 x 1.0-6H	.305	7.7	.875	22.2	.938	23.8	1.58	40.1	1.52	38.6	.83	21.1	1.04	26.4	.93	23.6	.455	11.6
11	M15 x 1.0-6H	.305	7.7	.875	22.2	.938	23.8	1.58	40.1	1.52	38.6	.83	21.1	1.04	26.4	.93	23.6	.455	11.6
12	M17 x 1.0-6H	.404	10.3	1.000	25.4	1.125	28.6	1.66	42.2	1.67	42.4	.93	23.6	1.17	29.7	1.03	26.2	.598	15.2
14	M19 x 1.0-6H	.565	14.4	1.125	28.6	1.250	31.8	1.67	42.4	1.76	44.7	1.00	25.4	1.28	32.5	1.10	27.9	.710	18.0
16	M22 x 1.0-6H	.565	14.4	1.125	28.6	1.250	31.8	1.67	42.4	1.76	44.7	1.00	25.4	1.28	32.5	1.10	27.9	.710	18.0
18	M25 x 1.0-6H	.658	16.7	1.250	31.8	1.375	34.9	1.77	45.0	1.89	48.0	1.09	27.7	1.40	35.6	1.16	29.5	.839	21.3
20	M28 x 1.0-6H	.777	19.7	1.375	34.9	1.500	38.1	1.77	45.0	1.96	49.8	1.14	29.0	1.50	38.1	1.22	31.0	.934	23.7
22	M31 x 1.0-6H	.877	22.3	1.500	38.1	1.625	41.3	1.92	48.8	2.11	53.6	1.22	31.0	1.57	39.9	1.29	32.8	1.068	27.1
24	M34 x 1.0-6H	.999	25.4	1.625	41.3	1.750	44.5	1.95	49.5	2.18	55.4	1.28	32.5	1.67	42.4	1.36	34.5	1.197	30.4

Swing-Arm® Clamps

for Series 806 Mil-Aero Connectors

870V004 Swing-Arm Saddle Clamp, EMI Banding Adapter, Composite

CLAMP DIMENSIONS

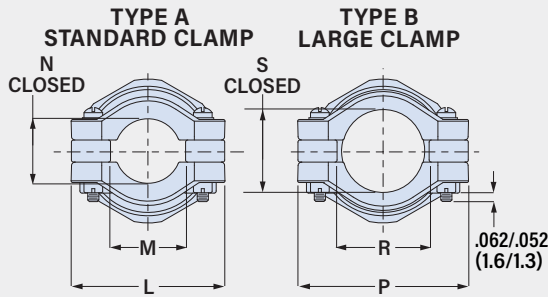

Standard Clamp						Large Clamp							
Shell Size	L Max in	M Min mm	M Min in	N Ref. in	N Ref. mm	Shell Size	P Max in	R Min mm	R Min in	S Ref. in	S Ref. mm		
08	.97	24.6	.22	5.6	.264	6.7	08	.98	24.9	.33	8.4	.356	9.0
09	.97	24.6	.22	5.6	.264	6.7	09	.98	24.9	.33	8.4	.356	9.0
10	1.03	26.2	.29	7.4	.310	7.9	10	1.20	30.5	.45	11.4	.422	10.7
11	1.03	26.2	.29	7.4	.310	7.9	11	1.20	30.5	.45	11.4	.422	10.7
12	1.21	30.7	.34	8.6	.422	10.7	12	1.45	36.8	.62	15.7	.637	16.2
14	1.32	33.5	.45	11.4	.538	13.7	14	1.54	39.1	.68	17.3	.707	18.0
16	1.32	33.5	.45	11.4	.538	13.7	16	1.54	39.1	.68	17.3	.707	18.0
18	1.45	36.8	.55	14.0	.590	15.0	18	1.60	40.6	.80	20.3	.759	19.3
20	1.54	39.1	.65	16.5	.660	16.8	20	1.73	43.9	.90	22.9	.841	21.4
22	1.67	42.4	.74	18.8	.744	18.9	22	1.95	49.5	1.05	26.7	.996	25.3
24	1.79	45.5	.87	22.1	.826	21.0	24	2.08	52.8	1.18	30.0	1.060	26.9

MATERIAL/FINISH

- Coupling nut, body, arms, saddles: polyetherimide (PEI)/ unplated black
- Screws, washers, inserts: stainless steel/ passivated
- Anti-decoupling springs: thermoplastic
- Banding adapter: aluminum alloy or brass
- Band (optional): stainless steel/ passivated
- Clinch Nuts: stainless steel/ silver plated

BAND INFORMATION

Terminate cable braid to band adapter with optional pre-coiled banding strap. Glenair's Band-Master ATS® banding system provides quick, easy, cost-effective and highly reliable termination. Band is passivated stainless steel.



Shell Size	Pre-Coiled Micro Band Part No.	Pre-Coiled Slim Micro Band Part No.	Length		Max Diameter	
			in	mm	in	mm
8 - 12	601-061	601-601	8.0	203	.88	22.4
14 - 24	601-065	601-603	14.0	356	1.88	47.8