



## 233-105-00, D0 and T0 MIL-DTL-38999 Series III Type Wall Mount Environmental Receptacle Connector

TABLE II: FINISH		
SYM	MATERIAL	FINISH
<b>XM</b>	Composite	Electroless Nickel
<b>XMT</b>	Composite	Ni-PTFE 1000 Hour Grey™
<b>XW</b>	Composite	Cadmium O.D. Over Electroless Nickel

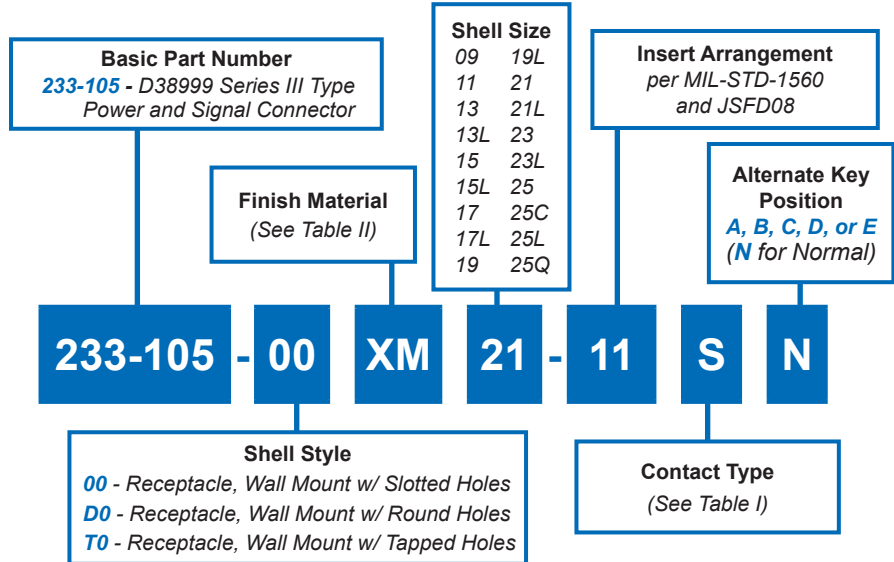
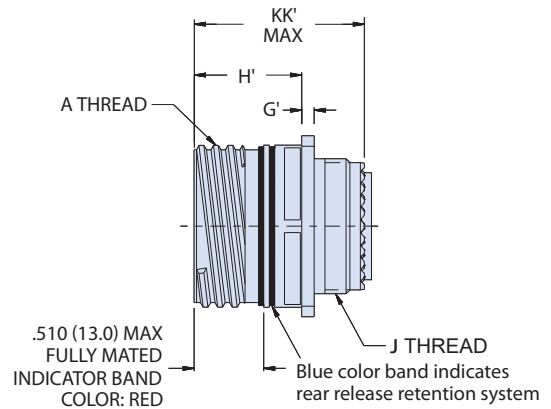
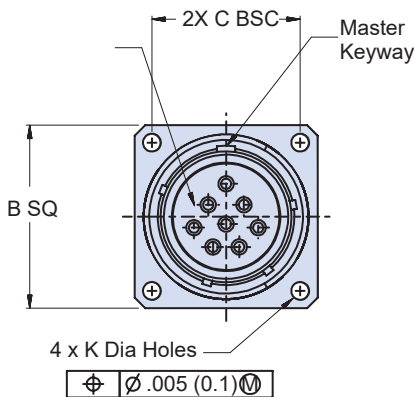

TABLE I: CONTACT TYPES				
Ordering Code	Assembly Dash Number	Wire Size	Type	Military Part Number
P	850-002-16-364	#16 – #20	Pin	M39029/58-364
S	850-001-16-352	#16 – #20	Socket	M39029/56-352
A	Less pin contacts			
B	Less socket contacts			



**D0 - ROUND HOLES**



**00 - SLOTTED HOLES**

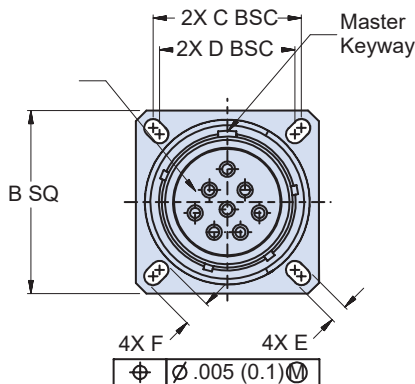

**T0 - TAPPED HOLES**

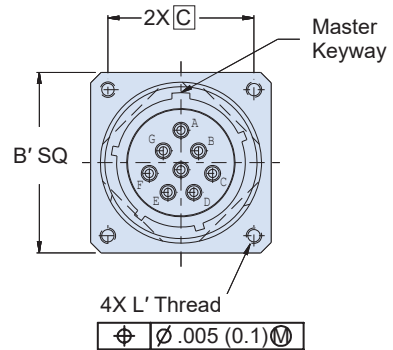

**F**

**233-105-00, D0 and T0  
MIL-DTL-38999 Series III Type  
Wall Mount Environmental Receptacle Connector**



**TABLE III: SHELL SIZE**

Shell Size Code	Shell Size	A Thread	B SQ	B' SQ	C BSC	D BSC	E	F	G'	H'	J Thread	L' Thread	KK' MAX	K Holes Dia
A	09	.6250-1P- .3L-TS-2A	.949 (24.1) .925 (23.5)	1.039 (26.39) .999 (25.37)	.719 (18.3)	.594 (15.1)		.224 (5.7) .208 (5.3)			M12 x 1.0- 6g 0.100R			
B	11	.7500-1P- .3L-TS-2A	1.043 (26.5) 1.019 (25.9)	1.132 (28.75) 1.092 (27.74)	.812 (20.6)	.719 (18.3)		.202 (5.1) .186 (4.7)			M15 x 1.0- 6g 0.100R			
C	13	.8750-1P- .3L-TS-2A	1.138 (28.9) 1.114 (28.3)	1.226 (31.14) 1.186 (30.12)	.906 (23.0)	.812 (20.6)			.144 (3.7)	.823 (20.9) .768 (19.5)	M18 x 1.0- 6g 0.100R			
D	15	1.0000-1P- .3L-TS-2A	1.232 (31.3) 1.208 (30.7)	1.289 (32.74) 1.249 (31.72)	.969 (24.6)	.906 (23.0)	.136 (3.5) .120 (0.1)	.181 (4.6) .165 (4.2)			M22 x 1.0- 6g 0.100R	M3X0.5		.136 (3.5) .120 (3.0)
E	17	1.1875-1P- .3L-TS-2A	1.323 (33.6) 1.299 (33.0)	1.382 (35.10) 1.342 (34.09)	1.062 (27.0)	.969 (24.6)					M25 x 1.0- 6g 0.100R		1.260 (32.00)	
F	19	1.2500-1P- .3L-TS-2A	1.449 (36.8) 1.425 (36.2)	1.476 (37.49) 1.436 (36.47)	1.156 (29.4)	1.062 (27.0)		.202 (5.1) .186 (4.7)			M28 x 1.0- 6g 0.100R			
G	21	1.3750-1P- .3L-TS-2A	1.575 (40.0) 1.551 (39.4)	1.582 (40.18) 1.542 (39.17)	1.250 (31.8)	1.156 (29.4)					M31 x 1.0- 6g 0.100R			
H	23	1.5000-1P- .3L-TS-2A	1.701 (43.2) 1.677 (42.6)	1.739 (44.17) 1.699 (43.15)	1.375 (34.9)	1.250 (31.8)	.162 (4.1)	.250 (6.4)	.171 (65.2) .083 (39.8)	.791 (20.0) .736 (18.7)	M34 x 1.0- 6g 0.100R			.162 (4.1)
J	25	1.6250-1P- .3L-TS-2A	1.823 (46.3) 1.799 (45.7)	1.884 (47.85) 1.824 (46.33)	1.500 (38.1)	1.375 (34.9)	.146 (3.7)	.234 (5.9)			M37 x 1.0- 6g 0.100R	M4X0.7		.146 (3.7)

**TABLE IV: PANEL CUTOUTS**

Shell Size Code	Shell Size	M Ø Min	N Ø Min	P Ø Holes	R BSC
A	09	.656 (16.7)	.516 (13.1)	.133 (3.4) .123 (3.1)	.719 (18.3)
B	11	.796 (20.2)	.625 (15.9)	.133 (3.4) .123 (3.1)	.812 (20.6)
C	13	.922 (23.4)	.750 (19.1)	.133 (3.4) .123 (3.1)	.906 (23.0)
D	15	1.047 (26.6)	.906 (23.0)	.133 (3.4) .123 (3.1)	.969 (24.6)
E	17	1.219 (31.0)	1.016 (25.8)	.133 (3.4) .123 (3.1)	1.062 (27.0)
F	19	1.297 (32.9)	1.141 (29.0)	.133 (3.4) .123 (3.1)	1.156 (29.4)
G	21	1.422 (36.1)	1.266 (32.2)	.133 (3.4) .123 (3.1)	1.250 (31.8)
H	23	1.547 (39.3)	1.375 (34.9)	.159 (4.0) .149 (3.8)	1.375 (34.9)
J	25	1.672 (42.5)	1.484 (37.7)	.155 (3.9) .145 (3.7)	1.500 (38.1)

