

Military Standard Type Circular Filter Connectors



MIL-DTL-38999
Type

B

Product Selection Guide

MIL-DTL-38999
Series I Type
Page B-2

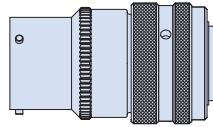

MIL-DTL-38999 Series I Type Filter Connectors
with Bayonet Coupling

MIL-DTL-38999
Series II Type
Page B-16

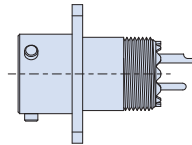

MIL-DTL-38999 Series II Type Filter Connectors
Low-Profile with Bayonet Coupling

MIL-DTL-38999
Series III Type
Page B-26

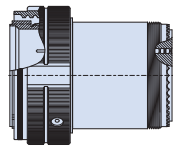

MIL-DTL-38999 Series III Type Filter Connectors
with Threaded Coupling

MIL-DTL-38999
Series IV Type
Page B-48

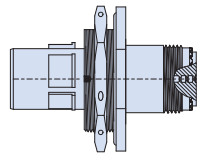

MIL-DTL-38999 Series IV Type Filter Connectors
with Breech-Lock Coupling

MIL-DTL-26482
Series II Type
Page B-60

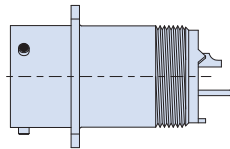

MIL-DTL-26482 Series II Type Filter Connectors
with Bayonet Coupling

MIL-DTL-83723
Series III Type
Page B-70

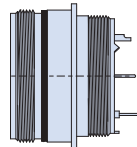

MIL-DTL-83723 Series III Type Filter Connectors

ITS Series,
VG95234 Type
Page B-86

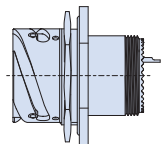

ITS Series, VG95234 Type Filter Connectors
with Reverse-Bayonet Coupling

MIL-DTL-5015
Series III Type
Page B-96

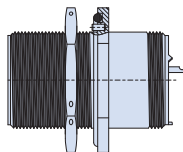

MIL-DTL-5015 Series III Type Filter Connectors

MIL-DTL-28840 Type
Page B-106

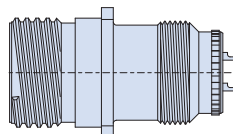

MIL-DTL-28840 Type Filter Connectors
with Threaded Coupling

Dimensions in inches (millimeters) and are subject to change without notice.

© 2013 Glenair, Inc.

U.S. CAGE Code 06324

Printed in U.S.A.

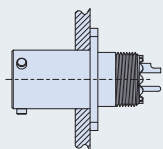
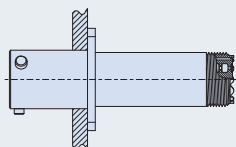
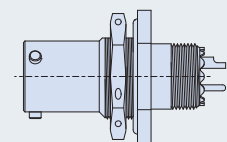
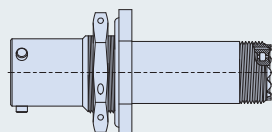
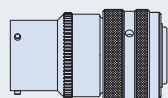
**240-381W****Wall Mount Receptacles****Page
B-6****240-381R****Wall Mount Receptacles
with Crimp Removable Contacts****Page
B-8****240-381J****Jam Nut Receptacles****Page
B-10****240-381S****Jam Nut Receptacles
with Crimp Removable Contacts****Page
B-12****240-381A****Connector Adapters****Page
B-14**

Notes

1. Materials/Finishes: Shells, Barrel, Coupling Nut, Jam Nut - See Table I
Insulators - High grade rigid dielectric/N.A.
Seals - Fluorosilicone
Contacts: Copper alloy 50 μ " Gold over 50 μ " Nickel
2. Assembly to be identified with Glenair's name, part number, and date code - space permitting.
3. Insert Arrangement in accordance with MIL-STD-1560. (Arrangement shown for reference only)
4. EMI Circular Filter Receptacle connectors designed to meet requirements of MIL-STD-2120 and MIL-DTL-38999, Series I.
5. All contacts to have identical filter value. Other filter arrangements available, contact factory.
6. Electrical Ratings: DWV- 500 VDC; Standard Operating Voltage 200 VDC (Filter class X, Y and Z are 250 VDC)
7. Insulation Resistance: 5000 MegOhms Min. at 200 VDC.
8. Operating Temperature: -55°C to +125°C (Env Class Connectors)
9. Other filter styles (C-L, L-C, Unbalanced Pi, Multi-Stage, Multi-Value) are available, please consult the factory.

Dimensions in inches (millimeters) and are subject to change without notice.