

### 792-003S Panel Mount Plug Connectors

#### Crimp Removable, Rear Release Contacts

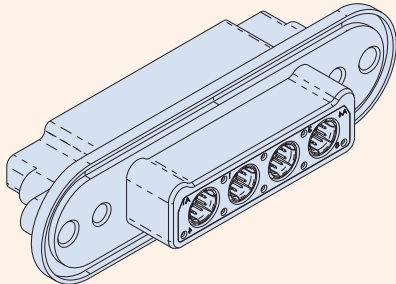

*Size 8 quadrx or Ochito contacts. Blind mate. Panel mount with O-ring.* Series 792 connectors are intended for 10Gb Ethernet, USB 3.0 and other multi-gigabit protocols. 792-003S panel mount connectors feature machined aluminum shells with polarizing lobes. Scoop-proof interface for problem-free service. *Crimp removable size 8 contacts* are purchased separately. "Combo" arrangements are supplied with unassembled size 23 crimp contacts. Military-grade performance and construction.

Technical Data	
Specifications	
<ul style="list-style-type: none"> <li>Operating temperature: -65° to +150°C</li> <li>Current rating, size 23 contact: 5A</li> <li>Voltage rating (DWV): 750 Vac, size 23 1800 Vac size 8 body to connector shell</li> <li>Wire size, #23 contact: AWG 22-28</li> <li>Shock: EIA-364-27 condition D</li> <li>Vibration: EIA-364-28 condition V, letter E</li> <li>Insulation Resistance: 5000 MΩ min.</li> <li>Shell-to-shell resistance with EMI spring: 2.5 mΩ max.</li> <li>Altitude immersion: 75,000 feet</li> </ul>	
Construction	
<ul style="list-style-type: none"> <li>Shell: aluminum alloy</li> <li>Metal insert: aluminum, nickel plated</li> <li>Insulators: high-grade rigid dielectric</li> <li>O-ring: code F fluorosilicone, code C silver plated aluminum-filled fluorosilicone, code S gold plated copper alloy</li> <li>Contacts: copper alloy, 50 microinches gold over nickel plating</li> <li>Wire grommet: fluorosilicone blend</li> <li>Contact retention clip, insert retention clip: copper alloy</li> <li>Hardware: 300 series SST, passivated</li> </ul>	

How To Order					
	Sample P/N → <b>792-003S</b>	<b>D-12W4</b>	<b>M</b>	<b>P</b>	<b>F</b>
<b>Product</b>	<b>792-003S</b> = Panel Plug, Socket Contacts				
<b>Insert Arrangement</b>	See Table 2				
<b>Shell Finish</b>	<b>M</b> = Electroless Nickel <b>MT</b> = Nickel-PTFE				
<b>Mating Hardware (Table 1)</b>	<b>N</b> = No hardware <b>P</b> = Jackpost <b>G</b> = Male guide pins				
<b>O-ring Option</b>	<b>N</b> = No O-ring <b>F</b> = Fluorosilicone O-ring (non-conductive) <b>C</b> = Conductive fluorosilicone O-ring <b>S</b> = Metal EMI panel spring (non-environmental)				

Table 1 Mating Hardware		
<p><b>N</b> <b>No Hardware</b> Blind tapped holes</p>	<p><b>P</b> <b>Jackposts</b> Non-removable 8-32 UNC-2B thread</p>	<p><b>G</b> <b>Guide Pins</b> Non-removable</p>

Table 2 Insert Arrangements					
Insert arrangement	Number of Contacts		Insert arrangement	Number of Contacts	
	#23	#8		#23	#8
<b>A-1W1, A-1G1*</b>		1	<b>D-27W3</b>	24	3
<b>A-3W1</b>	2	1	<b>D-4W4, D-4G4*</b>		4
<b>B-23W1</b>	22	1	<b>D-12W4</b>	8	4
<b>B-2W2, B-2G2*</b>		2	<b>E-45W3</b>	42	3
<b>B-6W2</b>	4	2	<b>E-5W5, E-5G5*</b>		5
<b>C-24W2</b>	22	2	<b>E-15W5</b>	10	5
<b>C-3W3, C-3G3*</b>		3	<b>F-9W9, F-9G9*</b>		9
<b>C-9W3</b>	6	3	<b>F-31W9</b>	22	9

Cavity identification numbers shown are for mating face of plug connectors with socket contacts.

\* Insert arrangements with "G" designator are grounded type with metal insert. Insert arrangements with "W" designator have thermoplastic dielectric.

# SERIES 792

## High-Speed Ultraminiature Rectangular Connectors



### 792-003S Panel Plug Connectors

#### Crimp Removable, Rear Release Contacts

#### Insertion/Removal Tools

Insertion/Removal Tool for Size 23 Contact	Removal Tool for Size 8 Contacts
<b>809-088</b> 	<b>859-049</b> (M81969/14-12) 

#### Size 23 Socket Contacts

Contact Part No.	Crimper	Positioner
<b>850-164</b> 	<b>809-015</b> (M22520/2-01) 	<b>859-214</b> (DMC# K2104) 

#### Polarizing Key Location and Contact Identification

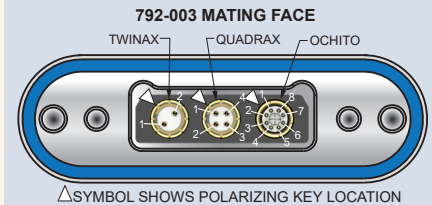

Series 792 connectors have a polarizing keyway in size 8 contact cavities. This keyway orients and aligns twinax, quadrax and El Ochito® contacts. The connector keyway is rotated 45° from top dead center. This illustration shows the location of the polarizing key and the contact numbers when looking at the mating face of the plug (socket) connector.

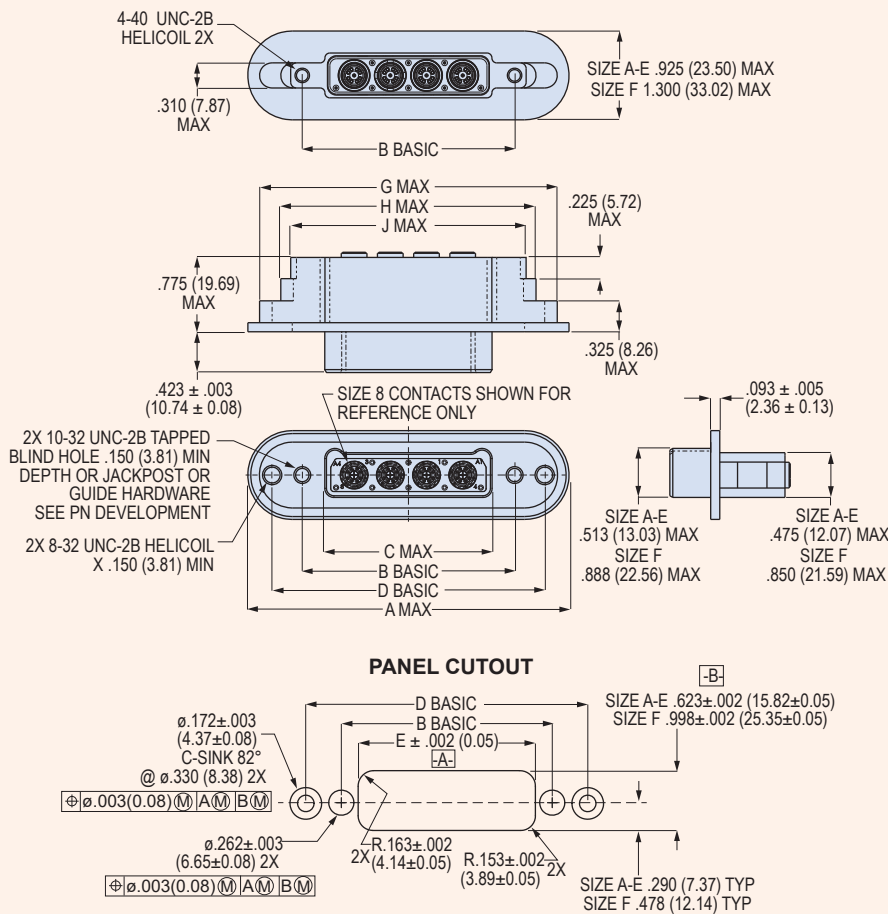

#### Size 8 Datalink Socket Contacts (not supplied with Connector)



#### 792-003S Dimensions

Shell Size	A Max		B Basic		C Max		D Basic		E ± .002 (0.06)		G Max		H Max		J Max	
	In.	mm.	In.	mm.	In.	mm.	In.	mm.	In.	mm.	In.	mm.	In.	mm.	In.	mm.
<b>A</b>	2.220	56.39	1.075	27.31	.615	15.62	1.699	43.15	.725	18.42	1.965	49.91	1.525	38.74	1.320	33.53
<b>B</b>	2.595	65.91	1.450	36.83	.990	25.15	2.074	52.68	1.100	27.94	2.340	59.44	1.900	48.26	1.695	43.05
<b>C</b>	2.970	75.44	1.825	46.36	1.365	34.67	2.449	62.20	1.475	37.47	2.715	69.96	2.275	57.79	2.070	52.58
<b>D</b>	3.345	84.96	2.200	55.88	1.740	44.20	2.824	71.73	1.850	46.99	3.090	74.49	2.650	67.31	2.445	62.10
<b>E</b>	3.720	94.49	2.575	65.41	2.115	53.72	3.199	81.25	2.225	56.52	3.465	88.01	3.025	76.84	2.820	71.63
<b>F</b>	3.720	94.49	2.575	65.41	2.115	53.72	3.199	81.25	2.225	56.52	3.465	88.01	3.025	76.84	2.820	71.63