

# Series 802 AquaMouse™ 3500 PSI Submersible Hermetic Jam-nut Mount Bulkhead Feed-Thru Receptacle

## 802-050 Ordering Information



Series 802



**Series 802 Hermetic Jam-Nut Mount, Bulkhead Feed-Thru Receptacles** provide a separable hermetic connection on both sides of a mounting panel. Features hermeticity of  $5 \times 10^{-8}$  sccHe/sec at 1 atmosphere differential. Gold plated iron alloy contacts and compression glass dielectric material. The passivated, stainless steel connector shell offers excellent corrosion protection. Available with pin to pin contacts. Power applied to a given contact on one end will result in power to contact directly opposite, regardless of contact identification letter. Shell sizes 5 thru 21 have a maximum open face rated test pressure of 1,000 PSI in one direction.

How To Order	
<b>Sample Part Number</b>	<b>802-050 Z1 12-37 P P A 01 N</b>
<b>Series</b>	<b>802-050 = Bulkhead Feed-Thru Hermetic Receptacle</b>
<b>Shell Material and Finish</b>	<b>Z1 = 316 Stainless Steel / Passivated RoHS Compliant</b>
<b>Shell Size - Insert Arrangement (See Table I)</b>	See Table III
<b>Contact Type Jam-Nut Side</b>	<b>P = Pin</b>
<b>Contact Type Opposite Side</b>	<b>P = Pin</b>
<b>Polarization (See Table II)</b>	<b>A = Normal B = Pos. B C = Pos. C D = Pos. D E = Pos. E F = Pos. F</b>
<b>Panel Thickness (See Table III)</b>	<b>-01 = .500/1.000 -02 = 1.000/1.500 -03 = 1.500/2.000 -04 = 2.000/2.500 -05 = 2.500/3.000 -06 = 3.000/3.500 -07 = 3.500/4.000</b>
<b>O-ring Material</b>	<b>V = Viton N = Nitrile NA = No external o-rings supplied (suggested material: Nitrile)</b>

Shell Size	Insert Arrangement(s)
5	-3
6	-1, -4, -6, -7, -23
7	-1, -10, -25
8	-1, -2, -13, -28, -200
9	-4, -19, -200, -201, -210
10	-2, -5, -26, -200, -201, -202
12	-2, -3, -7, -37, -200, -201, -220
14	-5, -12, -55, -235
15	-3, -7, -14, -85, -241
21	-12, -22, -130, -269

Panel Thickness Code	H Panel Thickness	J Maximum Length
-01	.500/1.000	2.450
-02	1.000/1.500	2.950
-03	1.500/2.000	3.450
-04	2.000/2.500	3.950
-05	2.500/3.000	4.450
-06	3.000/3.500	4.950
-07	3.500/4.000	5.450

Key Position	Key Rotation	
	A°	B°
<b>A Normal</b>	150°	210°
<b>B</b>	75°	210°
<b>C</b>	95°	230°
<b>D</b>	140°	275°
<b>E</b>	75°	275°
<b>F</b>	95°	210°

Contact Sizes	Test Voltage
23	750 Vac
20 HD	1000 Vac
16, 12	1800 Vac

### NOTES

- Mates with 802 series plugs
  - Hermeticity:  $5 \times 10^{-8}$  sccHe/sec
  - Electrical safety limits and maximum usage pressure to be determined by the customer
- I.R.: 20,000 megohms (test @ 500 VDC minimum)

Dimensions in Inches (millimeters) are subject to change without notice.

# Series 802 AquaMouse™ 3500 PSI Submersible Hermetic Jam-nut Mount Bulkhead Feed-Thru

## 802-050 Dimensions

### Jam-nut mount bulkhead Feed-Thru

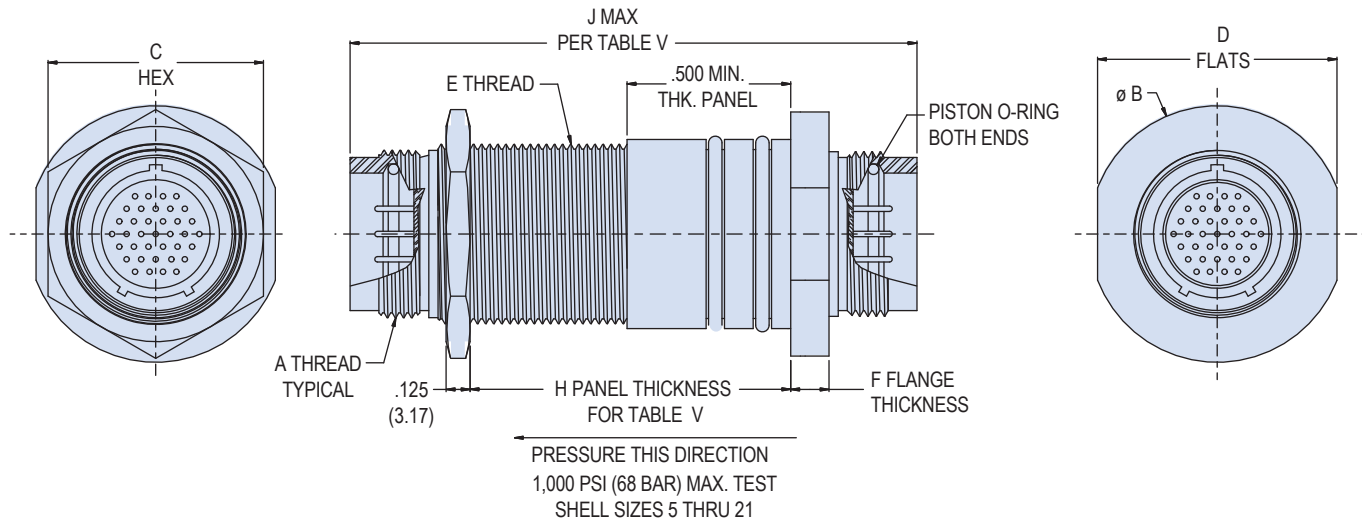

**Dimensions**

Shell Size	A Thread	Ø B Max	C Hex	D Flat	E Thread	Ø G	Ext. O-Ring	F
5	.4375-28 UNEF	.950 (24.13)	.688 (17.48)	.880 (22.35) .870 (22.10)	.5000-32 UN-2A	.562 (14.27)	2-013	.260 (6.60)
6	.5625-20 UN	1.150 (29.21)	.812 (20.62)	1.010 (25.65) 1.000 (25.40)	.6250-20 UN-2A	.687 (17.45)	2-.015	.260 (6.60)
7	.6250-20 UN	1.225 (31.12)	.875 (22.23)	1.080 (27.43) 1.070 (27.18)	.6875-28 UN-2A	.750 (19.05)	2-016	.260 (6.60)
8	.6875-20 UN	1.275 (32.39)	.938 (23.83)	1.140 (28.96) 1.130 (28.70)	.7500-28 UN-2A	.812 (20.62)	2-017	.260 (6.60)
9	.7500-20 UNEF	1.325 (33.65)	1.000 (25.40)	1.205 (30.61) 1.195 (30.35)	.8125-28 UN-2A	.875 (22.23)	2-018	.260 (6.60)
10	.8125-20 UNEF	1.380 (35.05)	1.000 (25.40)	1.270 (32.26) 1.260 (32.00)	.8750-28 UN-2A	.937 (23.80)	2-019	.260 (6.60)
12	.8750-20 UNEF	1.462 (37.13)	1.125 (28.58)	1.330 (33.78) 1.320 (33.53)	.9375-28 UN-2A	1.000 (25.40)	2-020	.260 (6.60)
14	1.0625-20 UN	1.650 (41.91)	1.312 (33.32)	1.520 (38.61) 1.510 (38.35)	1.1250-28 UN-2A	1.187 (30.15)	2-023	.325 (8.25)
15	1.1250-20 UN	1.700 (43.18)	1.375 (34.92)	1.580 (40.13) 1.570 (39.88)	1.1875-28 UN-2A	1.250 (31.75)	2-024	.325 (8.25)
21	1.4375-20 UN	2.165 (54.99)	1.700 (43.18)	2.015 (51.18) 2.005 (50.93)	1.5000-28 UN-2A	1.625 (41.28)	2-029	.325 (8.25)

**Jam-Nut Mount Bulkhead Feed-Thru, Panel Cutout Dimensions**

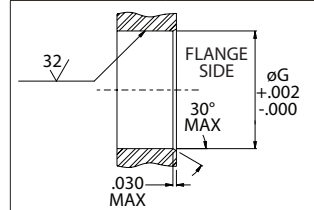

Shell Size	Ø G
5	.562 (14.27)
6	.687 (17.45)
7	.750 (19.05)
8	.812 (20.62)
9	.875 (22.23)
10	.937 (23.80)
12	1.000 (25.40)
14	1.187 (30.15)
15	1.250 (31.75)
19	1.625 (41.28)
21	1.263 (32.08)

#### Material/Finish

- Shell, jam-nut: SST / passivated
- Pin contacts: nickel-iron alloy/gold plate
- Insulators: high-grade rigid dielectric
- O-rings: specify, must be per Norsok M-710 standard / N.A.

Dimensions in Inches (millimeters) are subject to change without notice.