

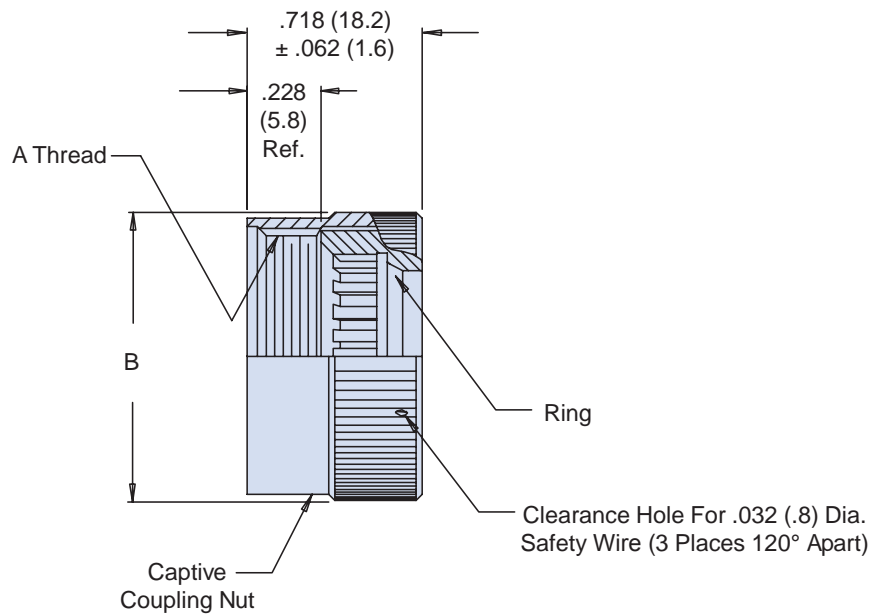

# MIL-DTL-28840/23 Non-Self-Locking E-Nut

**CONNECTOR DESIGNATOR:**
**G** MIL-DTL-28840

**Basic Part  
Number**
**Shell  
Size**
**M28840/23**
**- J**
**W**
**Material and Finish**
*D = Corrosion Resistant Steel,  
Cadmium Plate, Black*
*W = Aluminum, Cadmium Olive Drab*

**TABLE I: Shell Size, Shell Size Ref, Thread and Dimensions**

Shell Size	Shell Size Ref.	A Thread Class 2B	Ø B Max
A	11	.750 - 20 UNEF	1.028 (26.1)
B	13	.875 - 20 UNEF	1.141 (29.0)
C	15	1.000 - 20 UNEF	1.263 (32.1)
D	17	1.125 - 18 UNEF	1.387 (35.2)
E	19	1.250 - 18 UNEF	1.513 (38.4)
F	23	1.438 - 18 UNEF	1.703 (43.3)
G	25	1.562 - 18 UNEF	1.825 (46.4)
H	29	1.875 - 16 UN	2.143 (54.4)
J	33	2.062 - 16 UNS	2.329 (59.2)

**APPLICATION NOTES**

1. Assembly to be identified with manufacturer's name and part number, space permitting.
2. For complete dimensions, see the applicable Military Specification.
3. Cable entry is defined as the accommodation range for the wire bundle or cable. Dimensions shown are not intended for inspection criteria.
4. Metric dimensions (mm) are in parentheses.

Dimensions in inches (millimeters) and are subject to change without notice.