



SERIES GHTM WELL-MASTER 260° Downhole Micro-D Connector



Product selection guide

REFERENCE INFORMATION

Materials, contact arrangements,
and performance specifications

pg. 2

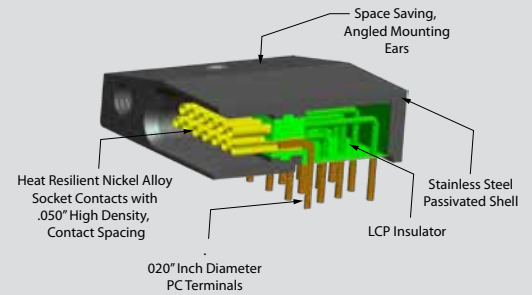

GHTM PIN/PLUG OR SOCKET/RECEPTACLE CONNECTORS

Well-Master® 260° pre-wired connectors
with insulated, +260° C PTFE/Polyamide wire

pg. 5



GHTM BACK-TO-BACK CONNECTORS

Well-Master® 260° cable assemblies available in plug-to-plug, receptacle-to-receptacle or plug-to-receptacle configurations. Made with +260° C PTFE/ Polyamide insulated wire

pg. 8

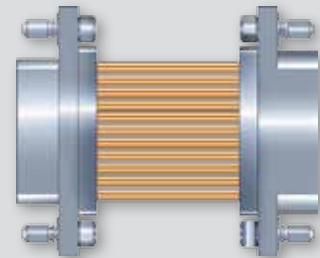

GHTM RIGHT ANGLE, PRINTED CIRCUIT BOARD

Well-Master® 260° right angle, printed circuit board connectors
with integral jackpost

pg. 11



DOWNHOLE: WELL-MASTER® 260°

